

NEW SITE PLAN
SCALE 1" = 30'

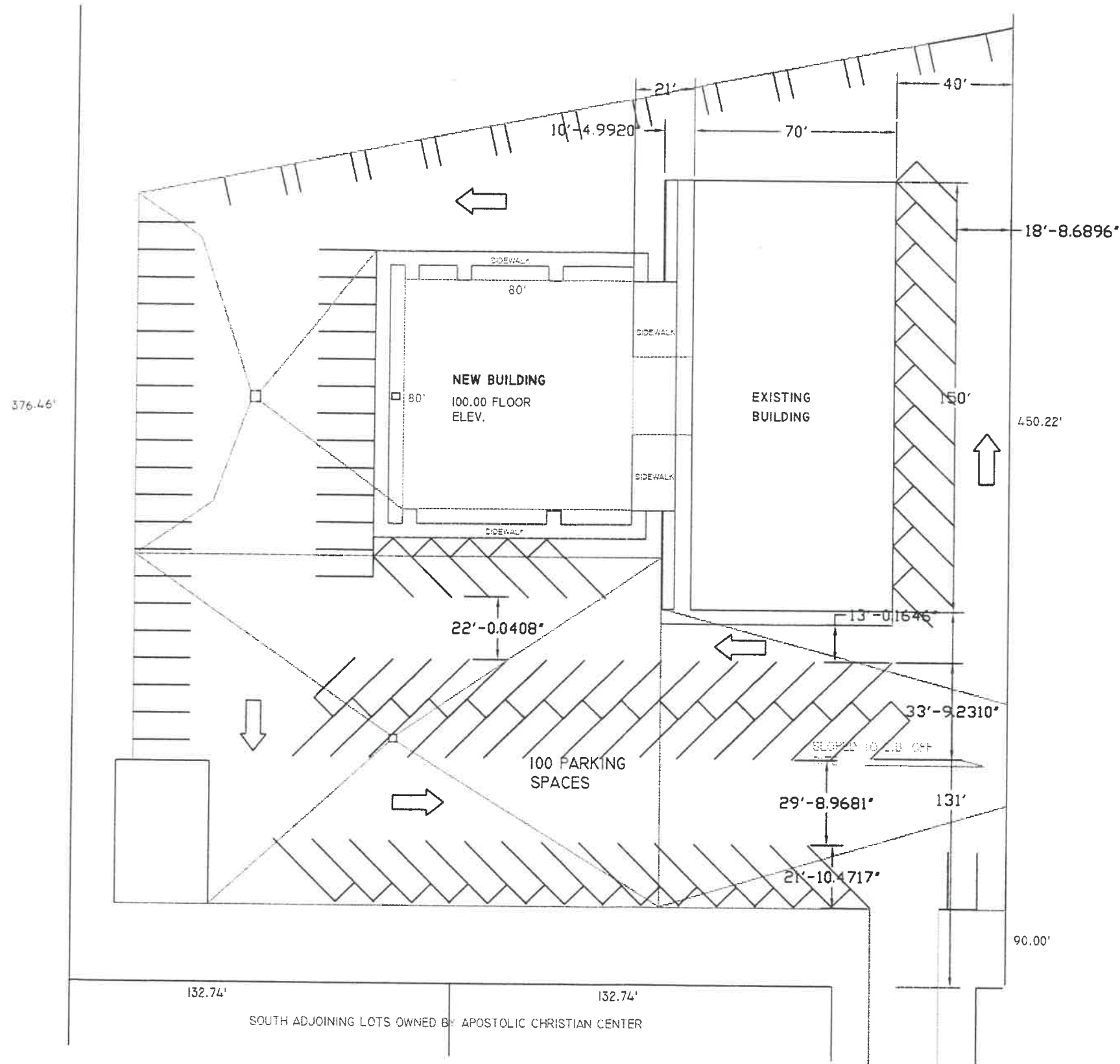

NEW SITE PLAN
SCALE 1" = 30'

CHAPTER 151: CITY OF NAPOLEON ZONING CODE

§ 151.67 REQUIRED WIDTHS OF PARKING AISLES AND DRIVEWAYS.

- (A) Parking area aisle widths shall conform to the following table, which varies the width requirement according to the angle of parking (see Table A).

Table A AISLE WIDTH PARKING REQUIREMENTS					
AISLE WIDTH	PARKING ANGLE (in degrees)				
	0	30	45	60	90
One-way traffic	13	11	13	18	24
Two-way traffic	19	20	21	23	24

- (B) Driveways shall be not less than ten (10) feet in width for one-way traffic and eighteen (18) feet in width for two-way traffic, except that ten (10) feet-wide driveways are permissible for two-way traffic when (i) the driveway is not longer than fifty (50) feet, (ii) it provides access to not more than six (6) spaces, and (iii) sufficient turning space is provided so that vehicles need not back into a public street.

John - Please layout parking for the Apostolic Christian Center according to the above chart.

Thanks
10-4-00
5:33 PM
Brent